

JI WALL 1150

Insulated panels (PIR core)

MR041 / 1116



JORISIDE
THE STEEL FUTURE
MEMBER OF JORIS IDE GROUP



Index

JI Wall 1150	1
Description	2
Weight and thermal performance	2
Materials	3
A1. External weather sheet	3
A2. Internal liner sheet (Liner profile)	3
A3. Insulation core	3
Confidex® Guarantee by Tata Steel	4
Performance	5
Certifications, Quality And Durability	5
Construction details for wall applications	6



Joris Ide Ltd. is not responsible for printing errors and / or any differences between the images in this catalogue and the final product delivered. Joris Ide Ltd. reserves the right to modify the technical specifications at any time without prior notice.

JI Wall 1150

Insulated panels (PIR core)

The JI Wall 1150 PIR insulated panel is a multi-functional panel with various uses, ranging from external wall applications to internal walls and ceilings. Due to the joint detail this panel is ideal for cold store and freezer rooms but also lends itself for uses within the agricultural market.

The Joris Ide group has more than 3 decades of experience, processes 300.000 tonnes of steel per year, has 17 production sites over 8 countries with the help of more than 1000 employees. Joris Ide, your dedicated partner.



JI Wall 1150 in industrial projects



JI Wall 1150 for cooling environment

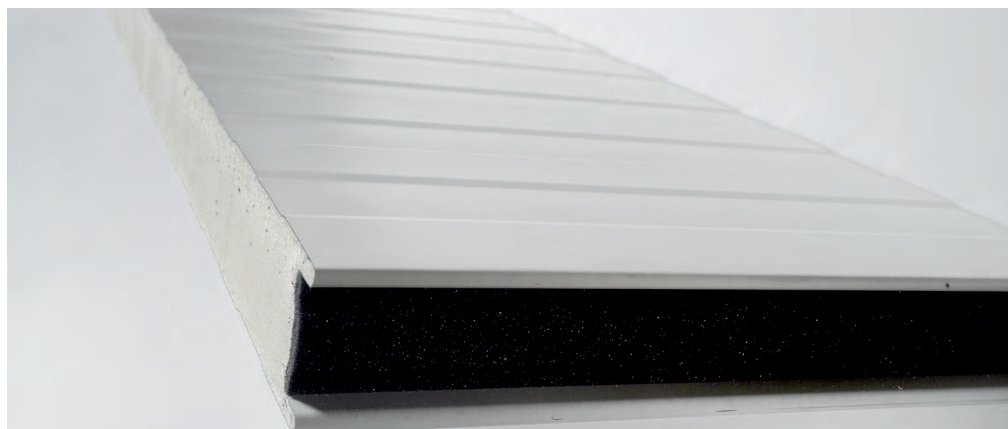

Detail of a panel

Description

The JI Wall 1150 PIR insulated panel is a multifunctional panel to be used from external wall to internal applications such as compartmentalizing and ceilings. Due to its innovative joint for core thicknesses until 200 mm, it is the ideal panel for cold store, freezer rooms, but also agricultural buildings such as poultry and others.

Applications

- Exterior walls and internal partitioning
- Cold store and freezer rooms
- Internal floor, walls and ceilings
- Food storage and processing plant
- Hygienic rooms

Product drawing

40 - 60 mm

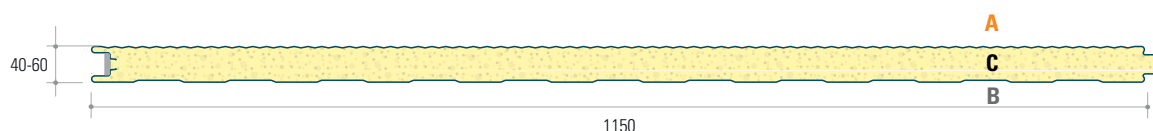

80 - 100 mm

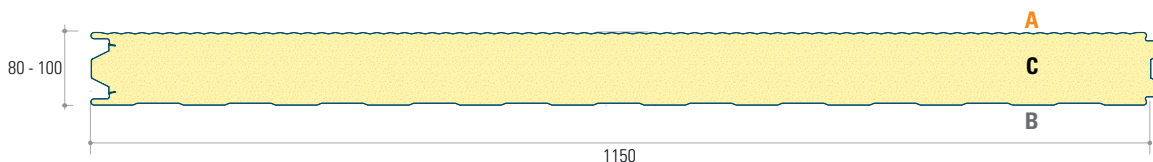

120 - 200 mm

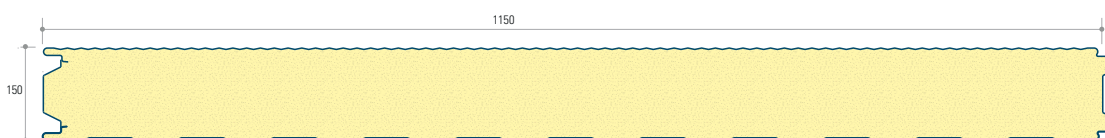

Profiling

Microrib



Liner



Smooth (for internal applications only)



Weight and thermal performance

Core Thickness (mm)	40	60	80	100	120	150	170	200
U-value (W/m ² K)	0,45	0,31	0,25	0,20	0,16	0,13	0,12	0,10
Weight (kg/m ²)	10,78	11,70	12,14	12,93	13,47	14,94	15,74	16,94

Materials

A1. External weather sheet

Joris Ide offers one of the widest ranges in coatings and colors which can be defined per project and building requirements. Please consult our color-flow for detailed information.



HPS 200 Ultra®

HPS 200µ Ultra: 5µ Primer + 200µ PVC coating + Scintilla embossing

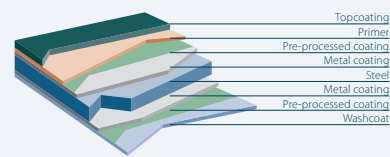

Prisma®

20 µ Primer + 30 µ PUR topcoat

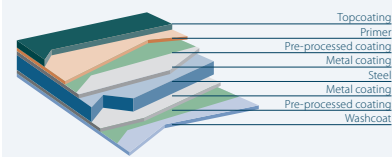

Ultra 60µ

25µ + 30µ PUR top coat

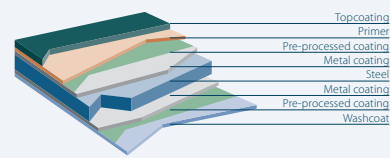

Essential 25µ

5µ Primer + 20µ Polyester

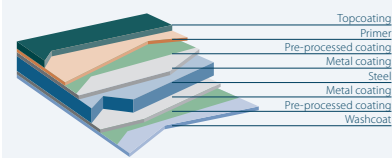

Foodsafe PVC 150µ

5µ primer + 150µ PVC film

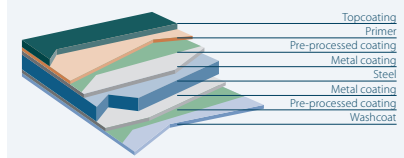

A2. Internal liner sheet (Liner profile)

Internal conditions of a building can vary; Joris Ide can offer a wide range to suit heavy-duty environments such as humidity and ammoniac. Please consult our colorflow for detailed information.

- 15 µ Polyester RAL 9002 (standard)
- 25 µ Polyester
- Colorfarm 35µ
- PVC Foodsafe 150 µ PVC
- Aluminium
- HPS 200 µ.
- Stainless steel

A3. Insulation core

Jl Wall 1150 insulated panels are made with a high thermal performance and environmental sustainable PIR foam with zero ozone depletion and a low global warming potential.

Confidex® Guarantee by Tata Steel

For over 20 years the Confidex® Guarantee from Tata Steel has remained best in class. Confidex® is the product performance guarantee for Colorcoat HPS200 Ultra® and Colorcoat Prisma®, when used in an external conventional building envelope application namely roof and wall cladding using single skin, built-up or composite panel construction in industrial and commercial buildings. Confidex® offers the longest and most comprehensive guarantee for pre-finished steel in Europe.

Key features include;

- Extended guarantee cover for up to 40 years on Colorcoat HPS200 Ultra® and up to 30 years on Colorcoat Prisma®.
- No requirement for annual inspections or maintenance to validate the guarantee.
- Covers cut edges produced under factory controlled conditions for the entire guarantee period.
- Backed by years of worldwide product testing and real world experience.
- Provides cover for roof pitches down to 1° and no distinction between different roof pitches above that.
- Offered directly to the building owner and provides a contractual relationship between Tata Steel and the building owner.
- Fully transferable should building ownership change.
- Helps reduce the level of risk for each part of the supply chain.
- Quick and simple online registration form.

With Confidex® registration



Without Confidex® registration



Other warranties

Whilst Confidex® has always been restricted to the weathering performance of the external cladding, Tata Steel has recognised the growing emergence of demanding internal environment projects, such as energy from waste plants, and may offer a non-Confidex® warranty on a case by case basis for Colorcoat HPS200 Ultra® used internally.

Application specific warranties are also available for non-standard cladding applications; i.e residential roofs, flashings and sectional roller shutter doors.

Regions covered by the Confidex® Guarantee



KEY

- Northern Europe – Zone 1
- Southern Europe – Zone 2
- For areas outside of Confidex® zones please contact Tata Steel for more information.

Notes

- Figures under the Coastal heading are for buildings within 1 km of any coast.
- Full terms and conditions of the Confidex® Guarantee are on the online application form, available from www.colorcoat-online.com/registration
- Confidex® must be registered within 3 months of the building completion date for the guarantee to be valid.
- The Confidex® Guarantee periods on the diagram above are applicable to Zone 1 and Zone 2. For more information visit www.colorcoat-online.com/confidexmap

Colorcoat HPS200 Ultra, Colorcoat Prisma, Confidex are trademarks of Tata Steel UK Limited.



Performance

Environmental

The JI Wall 1150 corresponds to the BRE Global Green Guide online generic specification Coated steel composite profiled panel with pentane blown PUR/PIR insulation and steel liner on steel support, structural steel frame with no internal finish (ref. 806600001) which achieves a summary rating of A+ within external wall construction. The production facility is fully ISO 14001 certified.

Dimensions & tolerances

Minimum length : 2,50 m – Maximum length : 14 m (shorter lengths possible upon demand)

Dimensions	Tolerances
Length < 3000 mm	± 5 mm
Length > 3000 mm	± 10 mm
Width (mm)	± 2 mm
Thickness (mm)	± 2 mm

Product tolerances according to EN 14509

Certifications, Quality And Durability

The JI Wall 1150 is manufactured according to the ISO 9001 and are assembled from high-quality raw materials which are selected by a detailed supply chain management and in-house laboratory controls. The product is produced to the highest quality standards such as EN 14509. The JI Wall 1150 carries the product conformity according to the European legislation and therefore all packs are CE-marked and carry the Declaration of Performance.



Assessed to ISO 9001
LPCB ref. N° 700



Accessories

Joris Ide can supply accessories such as flashings, ceiling systems and finishing profiles in PVC.

Maintenance composite panels

Joris Ide advises to do an annual inspection of the panels and to carry out any remedial work identified during inspection.

The maintenance & cleaning frequency is dependant on the application environment and actual pollution conditions of the composite panel. Exterior used panels need to be cleaned once per year. For interior used panels, the cleaning is dependant on the actual pollution conditions. The cleaning of building walls should be made from up to down manually or by suitable cleaning facilities. Please note that any cleaner which includes corrosive material is forbidden to be used for the cleaning. Specific cleaning processes as below:

- Use plenty of clean water to wash the panel's surface;
- Use soft cloth with diluted detergent to wipe the panel's surface softly;
- Use clean water again to wash the stains off;
- Check the panel's surface and special cleaning with detergent is needed, if some parts are still not clean;
- Use clear water to wash the panels' surface till all stains have been washed out.

Note:

Please don't clean if the panel's surface is hot (over 40 °C) because too fast volatility of the water will do harm to the coating. Please notice especially that suitable detergent should be chosen. Generally neutral detergent is OK. Please don't use strong alkaline detergent, such as potassium hydroxide, sodium hydroxide and also please don't use strong acid detergent, abrasive detergent and paint soluble detergent. We would suggest to clean a small part as an experiment before carrying out thorough cleaning of the whole project.

Construction details for wall applications

Side Lap Details (80, 100 mm) - Visible fixing, double joint

1. Damp proof mounting on site can be performed by placing a butyl cord on each side;
2. ... and siliconing the diabolo-shaped joint on each side.

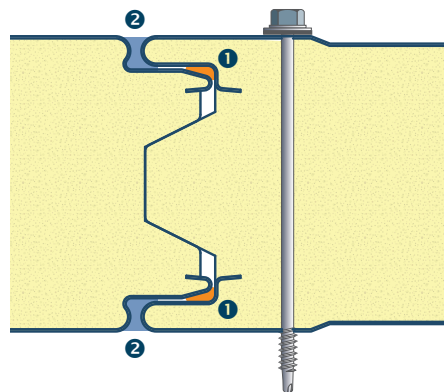

Side Lap Details (120, 150, 170, 200 mm) - Visible fixing, triple joint,

1. Damp proof mounting on site can be performed by placing a butyl cord on each side;
2. ... and siliconing the diabolo-shaped joint on each side.

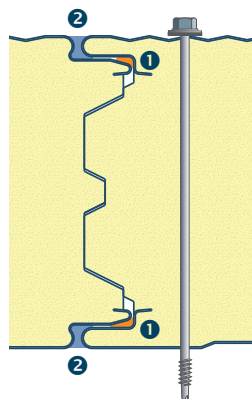

Construction details for wall applications

1. Coping flashing
2. JI Wall 1150 PIR
3. Site-applied waterproofing
4. Site-applied insulation
5. Joris Ide structural decking
6. Steel frame network
7. Hanger bar (M8 or M10)
8. Site-applied PIR foam
9. JI Wall 1150 panel
10. PVC nut (M8 or M10)
- 10+. Aluminium T-profile (coated in white)

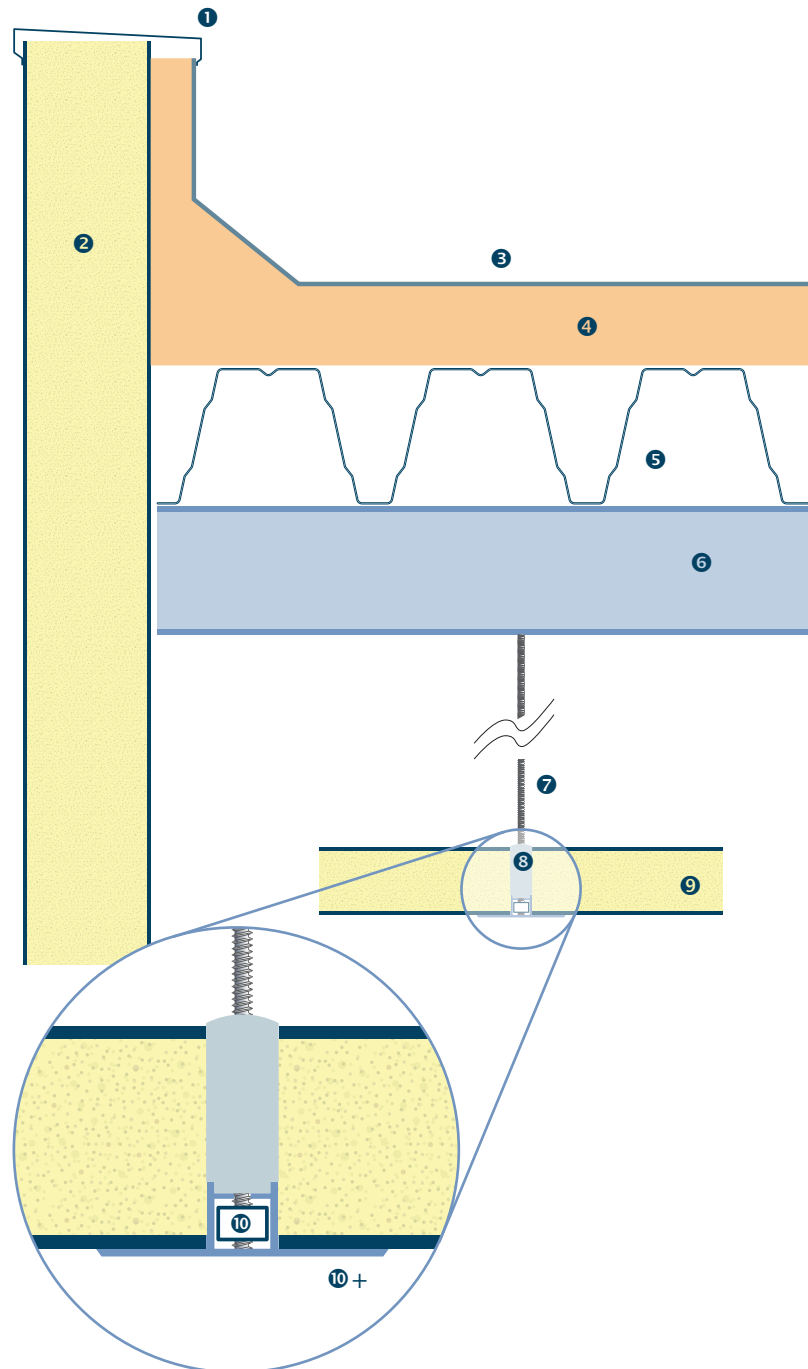



JI Wall 1150 in a renovation project.



JI Wall 1150 in fridge cell application.



JI Wall 1150 in agricultural application.

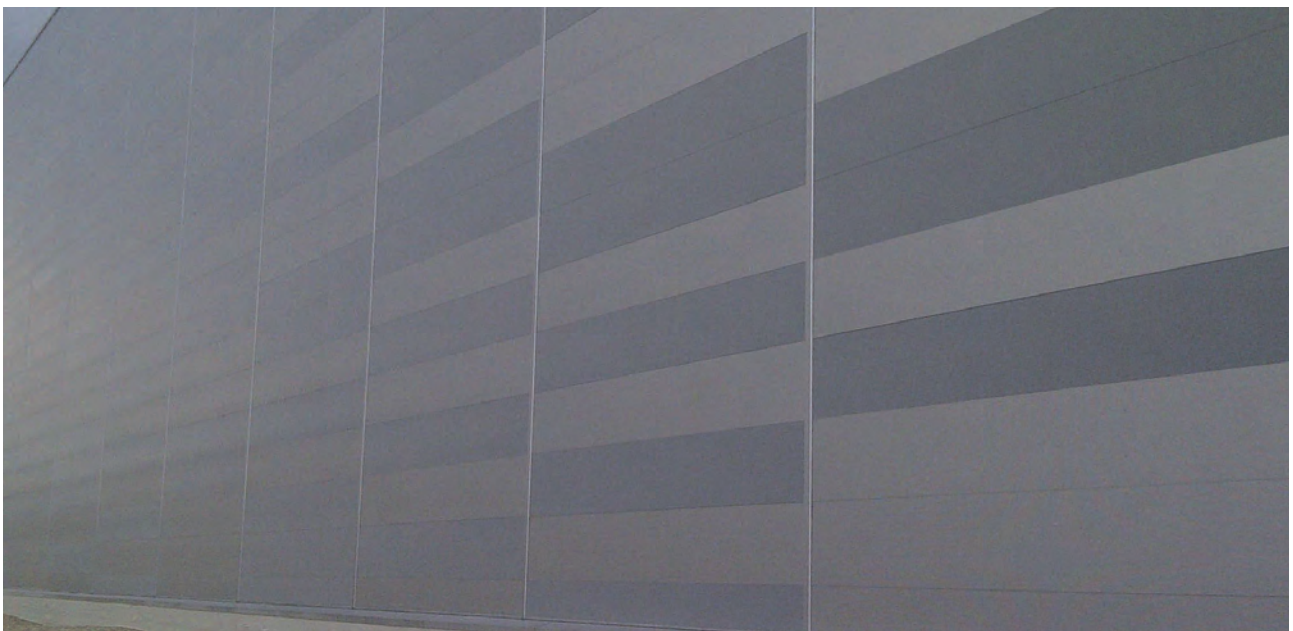

Industrial usage of the JI Wall 1150.



Commercial application.

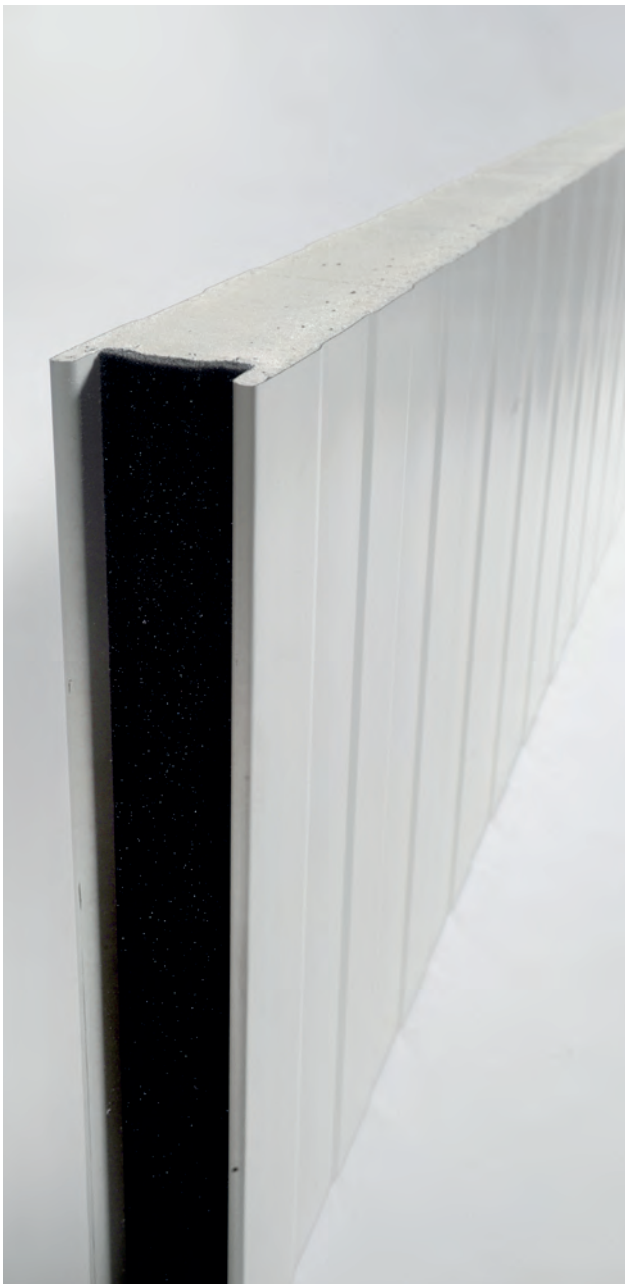

JI Wall 1150 detail view.



Corner and passage finish.



JI Wall 1150 in an industrial application.



Joris Ide Ltd.

A9, Elmbridge Court, Gloucester GL3 1JZ, United Kingdom
T. +44 (0)1452 412 069 F. +44 (0)1452 358 025 sales@joriside.co.uk

Joris Ide nv/sa

Hille 174, B-8750 Zwevezele, België
T. +32 (0) 51 61 07 77 F. +32 (0) 51 61 07 79 info@joriside.be